

**KING STUD SCHEDULE**

WALL	OPENING	8'-0" - 9'-0"	9'-0" - 10'-0"	10'-0" - 11'-0"	11'-0" - 12'-0"
2x4	0'-0" - 6'-0"	1	2	2	2
	6'-0" - 7'-0"	1	2	2	2
2x6	0'-0" - 12'-0"	2	2	2	2
	0'-0" - 7'-0"	1	1	1	1
2x8	0'-0" - 12'-0"	2	2	2	2
	0'-0" - 12'-0"	2	2	2	2

NOTE: 2-2x FULL HEIGHT STUDS ARE REQUIRED AT ALL HOLD-DOWN LOCATIONS

NOTE: SEE SPECS. FOR ALL STANDARD WALL NAILING CONDITIONS

**WALL FRAMING 1**

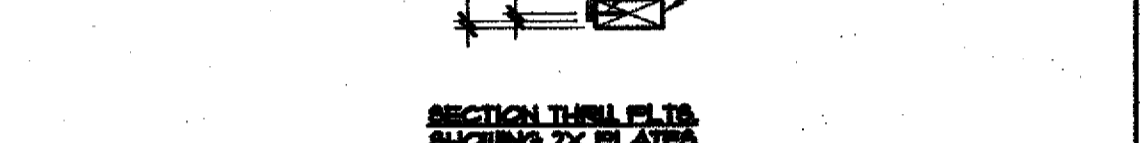
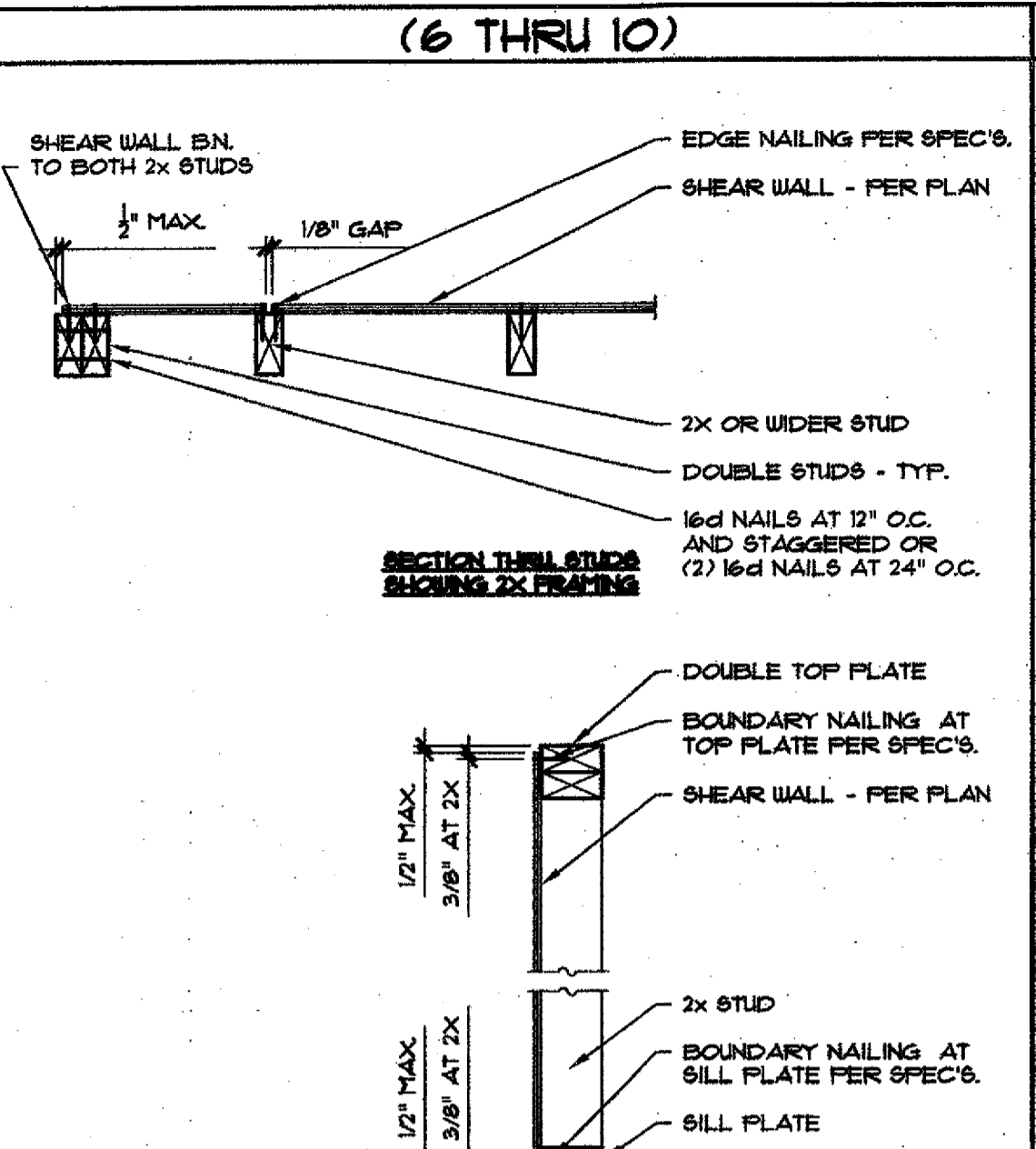

**TOP PLATE SPLICE 11**



**NOTCH & BORING 16**

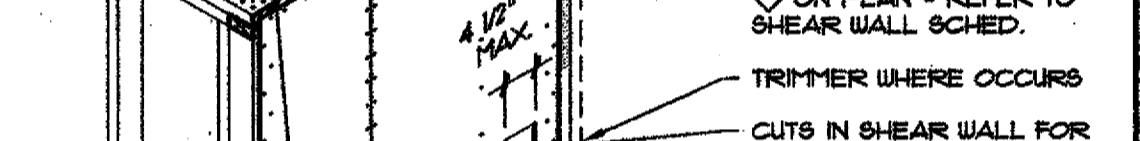

**NON-BRG WALL 21**

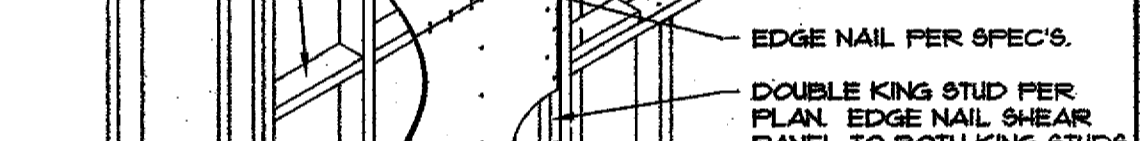

**TRUSS WEB BRACE 22**

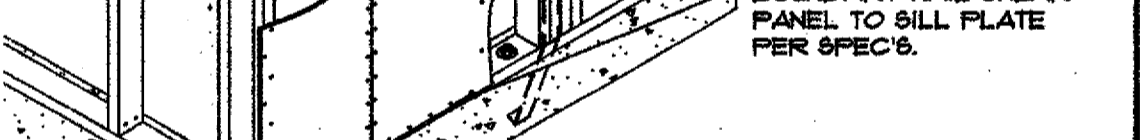

**DRAG TO BEAM 17**



**DRAG TO WALL AT GARAGE FRONT 13**

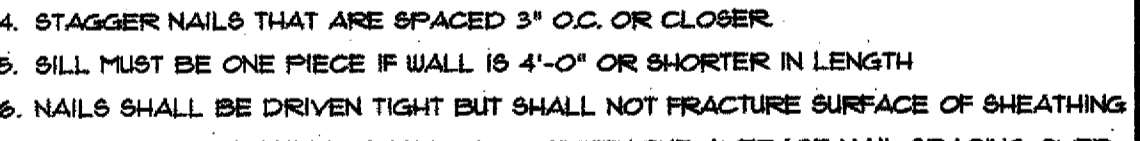

**SHEAR WALLS 6**



**SHT'G THRU. WALL 7**

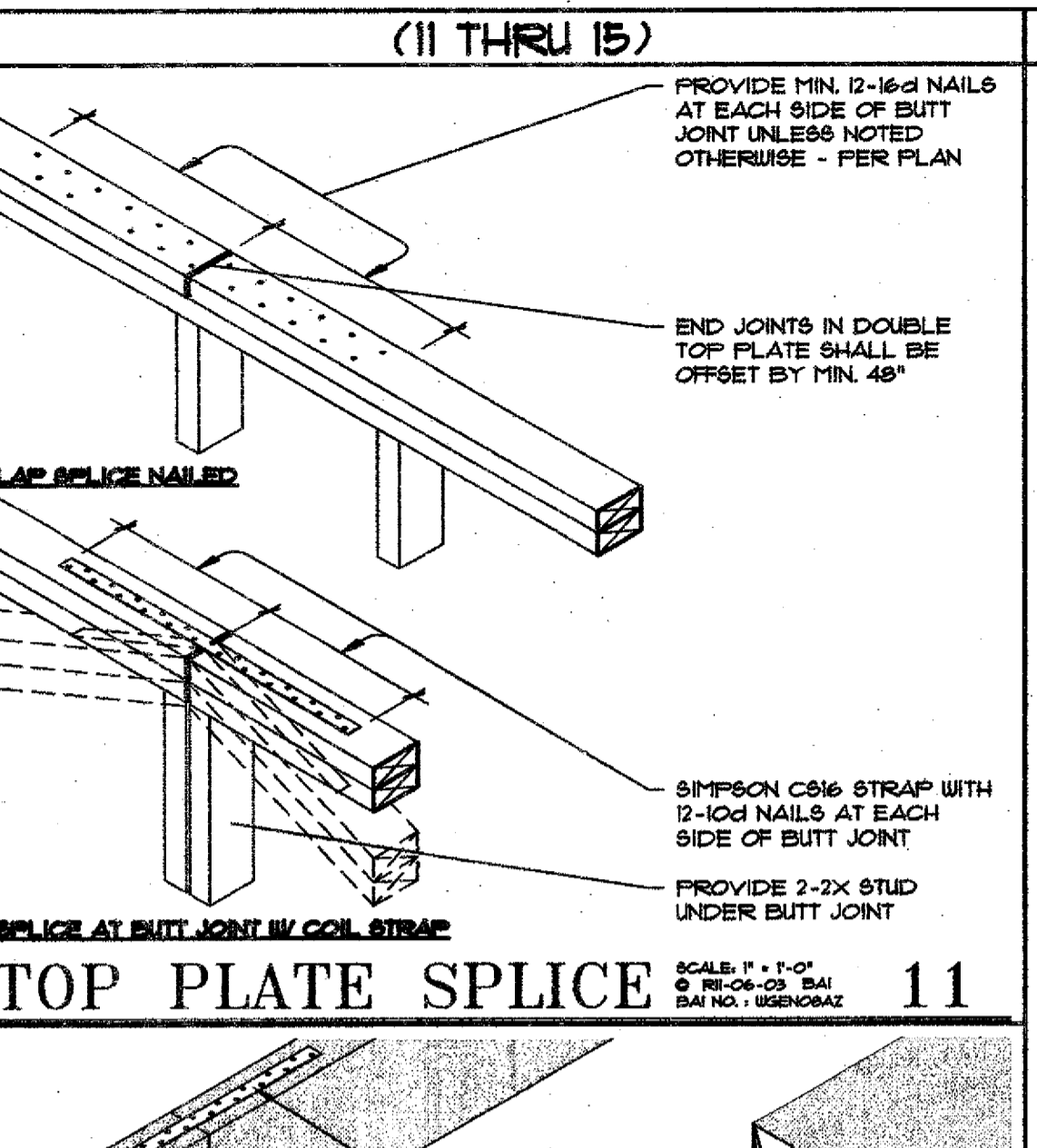

**KING STUD SCHEDULE**

WALL	OPENING	8'-0" - 9'-0"	9'-0" - 10'-0"	10'-0" - 11'-0"	11'-0" - 12'-0"
2x4	0'-0" - 6'-0"	1	2	2	2
	6'-0" - 7'-0"	1	2	2	2
2x6	0'-0" - 12'-0"	2	2	2	2
	0'-0" - 7'-0"	1	1	1	1
2x8	0'-0" - 12'-0"	2	2	2	2
	0'-0" - 12'-0"	2	2	2	2

NOTE: 2-2x FULL HEIGHT STUDS ARE REQUIRED AT ALL HOLD-DOWN LOCATIONS

NOTE: SEE SPECS. FOR ALL STANDARD WALL NAILING CONDITIONS

**WALL FRAMING 1**

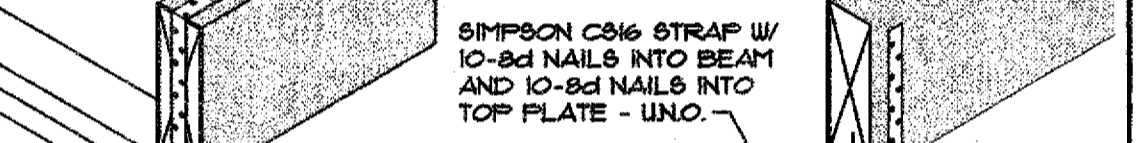

**SHEAR WALLS 6**

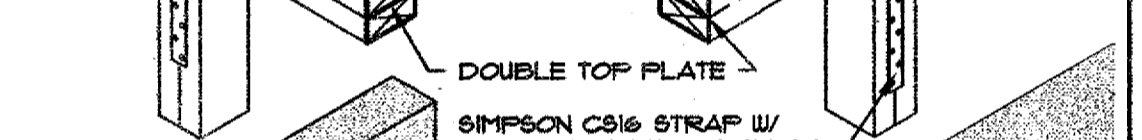

**TOP PLATE SPLICE 11**

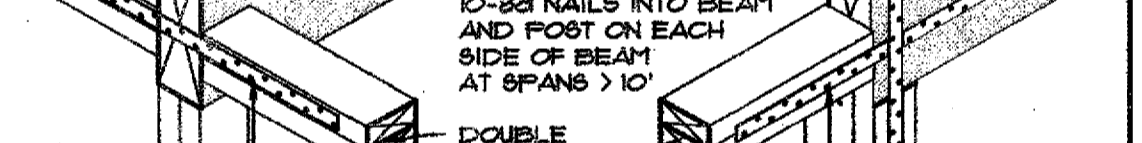

**NOTCH & BORING 16**

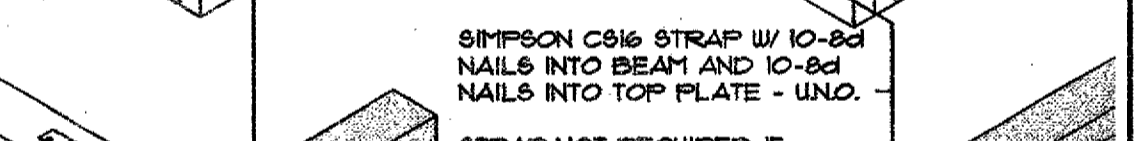

**NON-BRG WALL 21**

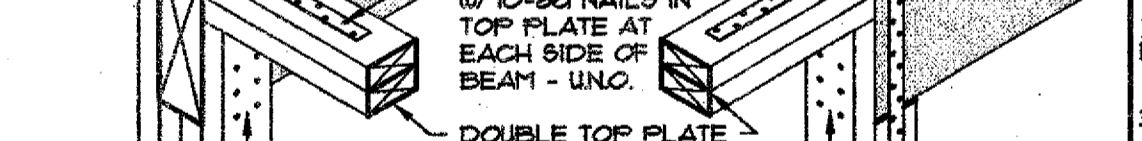

**TRUSS WEB BRACE 22**

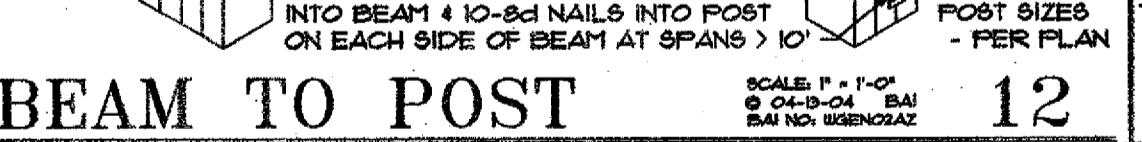

**DRAG TO BEAM 17**



**DRAG TO WALL AT GARAGE FRONT 13**



**SHEAR WALLS 6**



**SHT'G THRU. WALL 7**

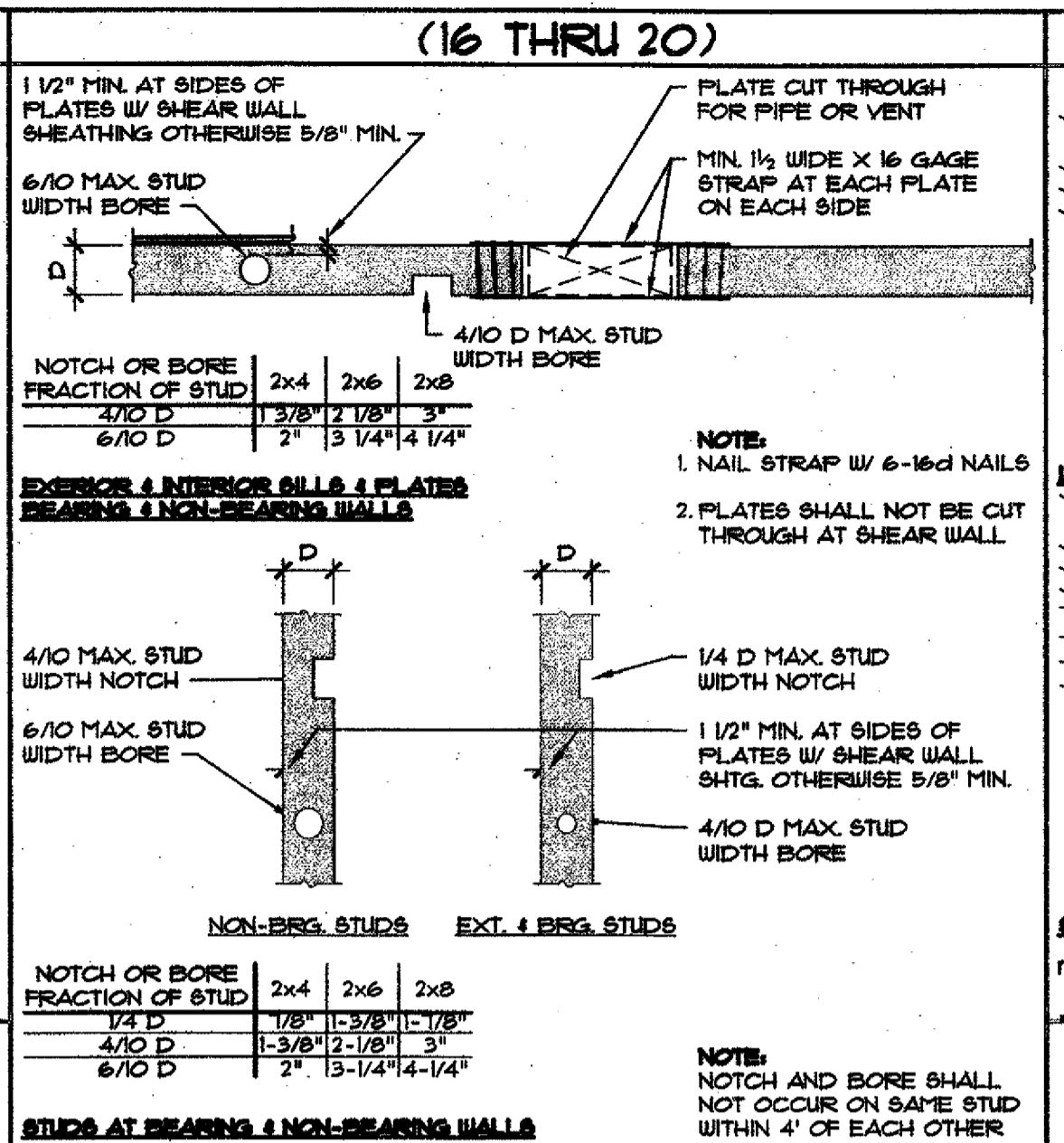

**KING STUD SCHEDULE**

WALL	OPENING	8'-0" - 9'-0"	9'-0" - 10'-0"	10'-0" - 11'-0"	11'-0" - 12'-0"
2x4	0'-0" - 6'-0"	1	2	2	2
	6'-0" - 7'-0"	1	2	2	2
2x6	0'-0" - 12'-0"	2	2	2	2
	0'-0" - 7'-0"	1	1	1	1
2x8	0'-0" - 12'-0"	2	2	2	2
	0'-0" - 12'-0"	2	2	2	2

NOTE: 2-2x FULL HEIGHT STUDS ARE REQUIRED AT ALL HOLD-DOWN LOCATIONS

NOTE: SEE SPECS. FOR ALL STANDARD WALL NAILING CONDITIONS

**WALL FRAMING 1**

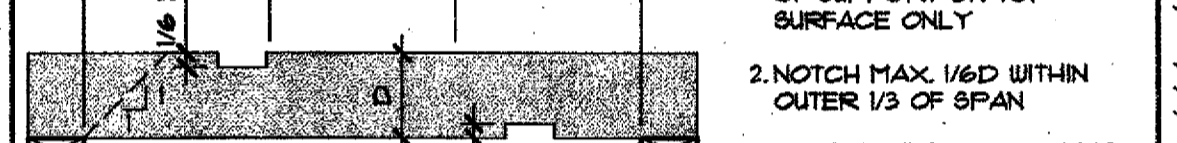

**SHEAR WALLS 6**

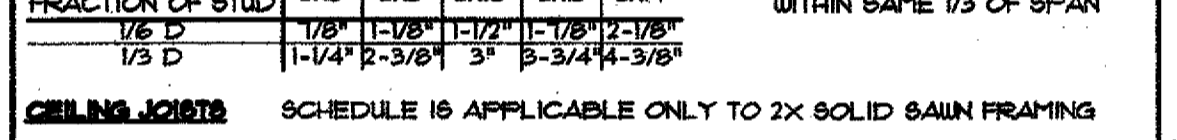

**TOP PLATE SPLICE 11**



**NOTCH & BORING 16**



**NON-BRG WALL 21**

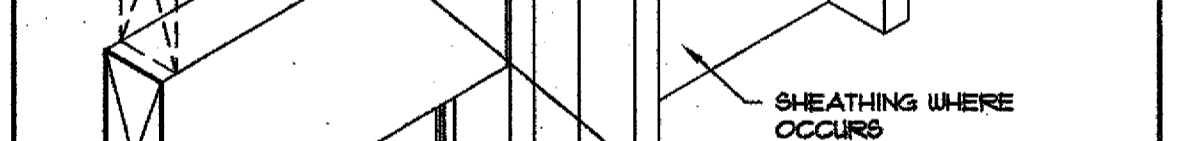

**TRUSS WEB BRACE 22**



**DRAG TO BEAM 17**

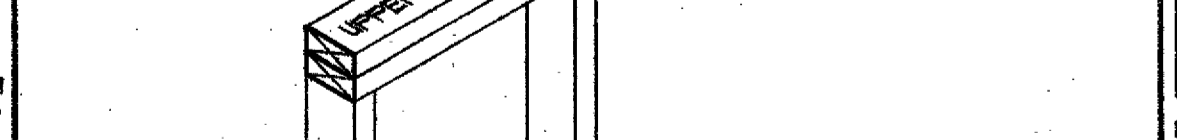

**DRAG TO WALL AT GARAGE FRONT 13**



**SHEAR WALLS 6**



**SHT'G THRU. WALL 7**

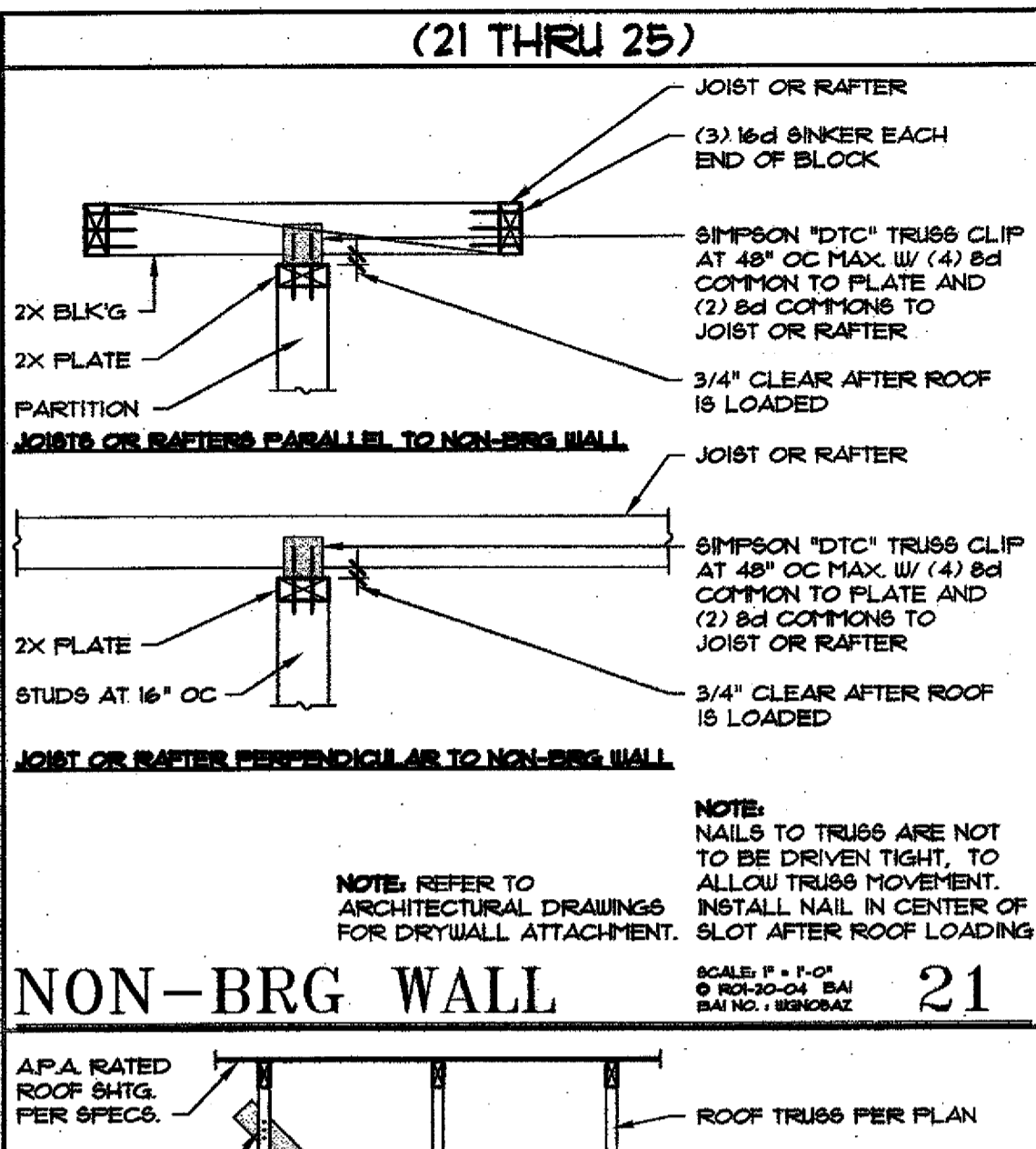

**KING STUD SCHEDULE**

WALL	OPENING	8'-0" - 9'-0"	9'-0" - 10'-0"	10'-0" - 11'-0"	11'-0" - 12'-0"
2x4	0'-0" - 6'-0"	1	2	2	2
	6'-0" - 7'-0"	1	2	2	2
2x6	0'-0" - 12'-0"	2	2	2	2
	0'-0" - 7'-0"	1	1	1	1
2x8	0'-0" - 12'-0"	2	2	2	2
	0'-0" - 12'-0"	2	2	2	2

NOTE: 2-2x FULL HEIGHT STUDS ARE REQUIRED AT ALL HOLD-DOWN LOCATIONS

NOTE: SEE SPECS. FOR ALL STANDARD WALL NAILING CONDITIONS

**WALL FRAMING 1**



**SHEAR WALLS 6**



**TOP PLATE SPLICE 11**

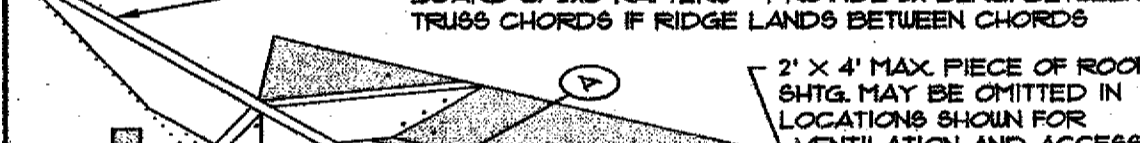

**NOTCH & BORING 16**

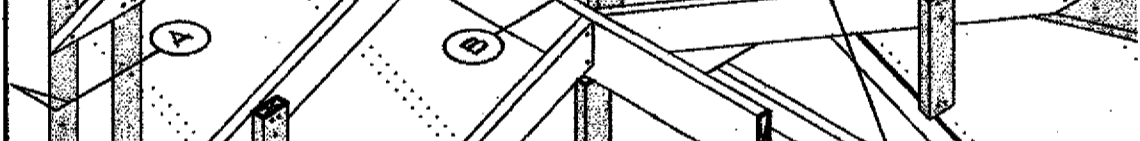

**NON-BRG WALL 21**



**TRUSS WEB BRACE 22**

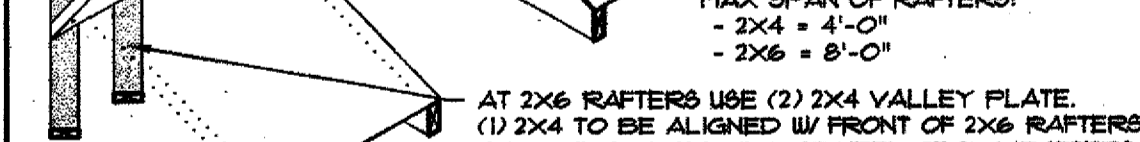

**DRAG TO BEAM 17**



**DRAG TO WALL AT GARAGE FRONT 13**

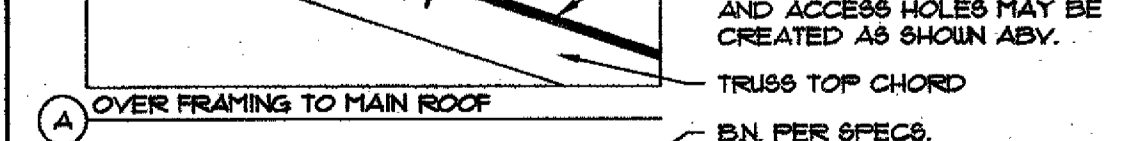

**SHEAR WALLS 6**



**SHT'G THRU. WALL 7**

**OVERFRAMING 23**

**DRAG 18**

**DRAG TO WALL AT GARAGE FRONT 13**

**SHT'G THRU. WALL 7**

**WALL FRAMING 1**