



PHOENIX OFFICE:
1920 North 7th Street, Suite 210
Phoenix, Arizona 85024
(623) 869-0601 Telephone
(623) 869-0603 Facsimile

CORPORATE OFFICE:
555 Anton Boulevard, Suite 250
Costa Mesa, California 92626
(714) 513-1500 Telephone
(714) 513-1555 Facsimile

E-Mail: webmail@borm.com
www.borm.com

COPYRIGHT 2007, BORM ASSOCIATES, INC.
ALL RIGHTS RESERVED

NOTICE:
THESE DRAWINGS AND SPECIFICATIONS AND THE IDEAL DESIGN, AND ARRANGEMENTS REPRESENTED THEREBY ARE AND SHALL REMAIN THE PROPERTY OF BORM ASSOCIATES, INC. AND NO PART THEREOF SHALL BE COPIED, DISCLOSED TO OTHERS OR USED IN CONNECTION WITH ANY OTHER WORK OR PROJECT OTHER THAN THE SPECIFIC PROJECT FOR WHICH THEY HAVE BEEN PREPARED AND DEVELOPED WITHOUT THE WRITTEN CONSENT OF BORM ASSOCIATES, INC. VISUAL CONTACT WITH THESE DRAWINGS OR SPECIFICATIONS SHALL CONSTITUTE CONCLUSIVE EVIDENCE OF THESE RESTRICTIONS.

WRITTEN DIMENSIONS ON THESE DRAWINGS SHALL HAVE PRECEDENCE OVER SCALED DIMENSIONS. CONTRACTORS SHALL VERIFY, AND BE RESPONSIBLE FOR ALL DIMENSIONS AND CONDITIONS ON THE JOB. THIS OFFICE MUST BE NOTIFIED OF VARIATIONS FROM THE DIMENSIONS AND CONDITIONS SHOWN BY THESE DRAWINGS.

- Foundation dimensions are extracted from architectural drawings. Borm Associates, Inc. has not assumed any liability with respect to these dimensions. Contractor shall verify all foundation dimensions with the architectural drawings and with field conditions. Contractor shall verify the location and sizes of all anchor bolts, holdowns, embedded straps and framing materials. Contractor shall verify configuration and location of all architectural features, such as but not limited to, depressions, slopes, shelves, patios, porches, and stoops.
- Contractor shall verify tendon lengths and stressing tail lengths prior to fabricating cables. Any discrepancies including but not limited to, dimensions, tendon count, lengths and elongation designation shall be brought to the attention of Borm Associates, Inc. prior to fabrication.
- For trenches adjacent to foundations, see detail (24/SD1O).
- For conventional reinforcing bar bends, see detail (2/SD1O). For stump and tie bends, see detail (1/SD1O).
- Refer to the soils report(s) for any pad preparation and pre saturation requirements.
- Stressing end and dead end of tendons may be reversed from that shown on the plans at Contractor's option. For anchorage of dead ends and general tendon layout, see detail (3/SD1O).
- The floor slab shall be poured level to within 1/8 inch in 10 feet.
- The floor slab, including garage floor slab, and foundation shall be poured monolithically except when shown otherwise.
- Anchor Bolts: Install anchor bolts as noted on the plans. If no notation is given, at exterior walls provide 1/2 inch dia. anchor bolts at 6 feet OC. In all bolted walls, at least one bolt shall be installed within 12 inches of each end of each plate, with no less than two (2) bolts per plate 12 inches or longer. 1/2 inch dia. anchor bolts may be replaced with Simpson MAB anchors. If no notation is given, at exterior walls provide MAB anchors at 32 inches OC. In all anchored walls, one MAB anchor shall be installed within 12 inches of each end of each plate, with no less than two (2) anchors per plate 12 inches or longer. Additional foundation reinforcing may be required. See details. See detail (6/SD1O).

Mark	Comment
AB, S * N" OC	Spacing of anchor bolts. Use 1/2 inch diameter unless noted otherwise. Set bolts for thicker than standard plate when necessary.

- Shot Pins: Install at all interior walls and partitions, where anchor bolts are not noted, 0.49 inch dia. x 2.875 inch shank length with metal plate washer at 36 inches OC. Each piece of plate longer than 16 inches shall have a minimum of two fasteners. At each end of each piece of plate in a wall indicated as a shear wall with shot pins place two fasteners, one at 6 inches and one at 10 inches from the end.
- Holdowns and Embedded Straps: See shear wall and architectural floor plan for reference in locating hardware and providing extension of hardware above concrete. It is the responsibility of the Contractor to determine their exact location. Hardware shall be tied in place prior to placement of concrete. For holdowns and embedded straps to foundation, see details (8/SD1O) and (10/SD1O).

- Tendons and conventional reinforcement shall be chained and tied in place prior to placement of concrete.
- Foundations: Size, depth, and reinforcement of continuous footings shall be as follows:

Exterior footings			Interior footing (ribs)		
Width	Depth	Typical * Reinforcement	Width	Depth (Overall Thickness)	Typical * Reinforcement
12"	12"	(1) 1/2" dia. tendon	12"	12"	none

- House floor slab: Reinforcement shall be chained and tied in place prior to placement of concrete. Base course shall be dispensed prior to placement of concrete. Slab and base course thickness given are actual not nominal

House floor slab thickness	Base layer
8"	4" A.B.C. MIN.

- Garage floor slab: Reinforcement shall be chained and tied in place prior to placement of concrete. Base course shall be dispensed prior to placement of concrete. Slab and base course thickness given are actual not nominal

Garage floor slab thickness	Base layer
8"	4" A.B.C. MIN.

- Exterior slab: Minimum 5 inch nominal concrete floor slab over natural grade or engineer certified compacted pad UNO. in project soils report. Steel reinforcing is not required.
- Care should be taken when drilling for the installation of wedge anchors or the drilling of shot pins to avoid slab tendons.
- If holdowns on plans are missed or are erroneously located, contact engineer of record for appropriate retrofit repair detail.
- Slab shall be permanently marked inside the garage door area as follows:

POST TENSION SLAB IN THIS BUILDING.
DO NOT DRILL OR CUT SLAB.

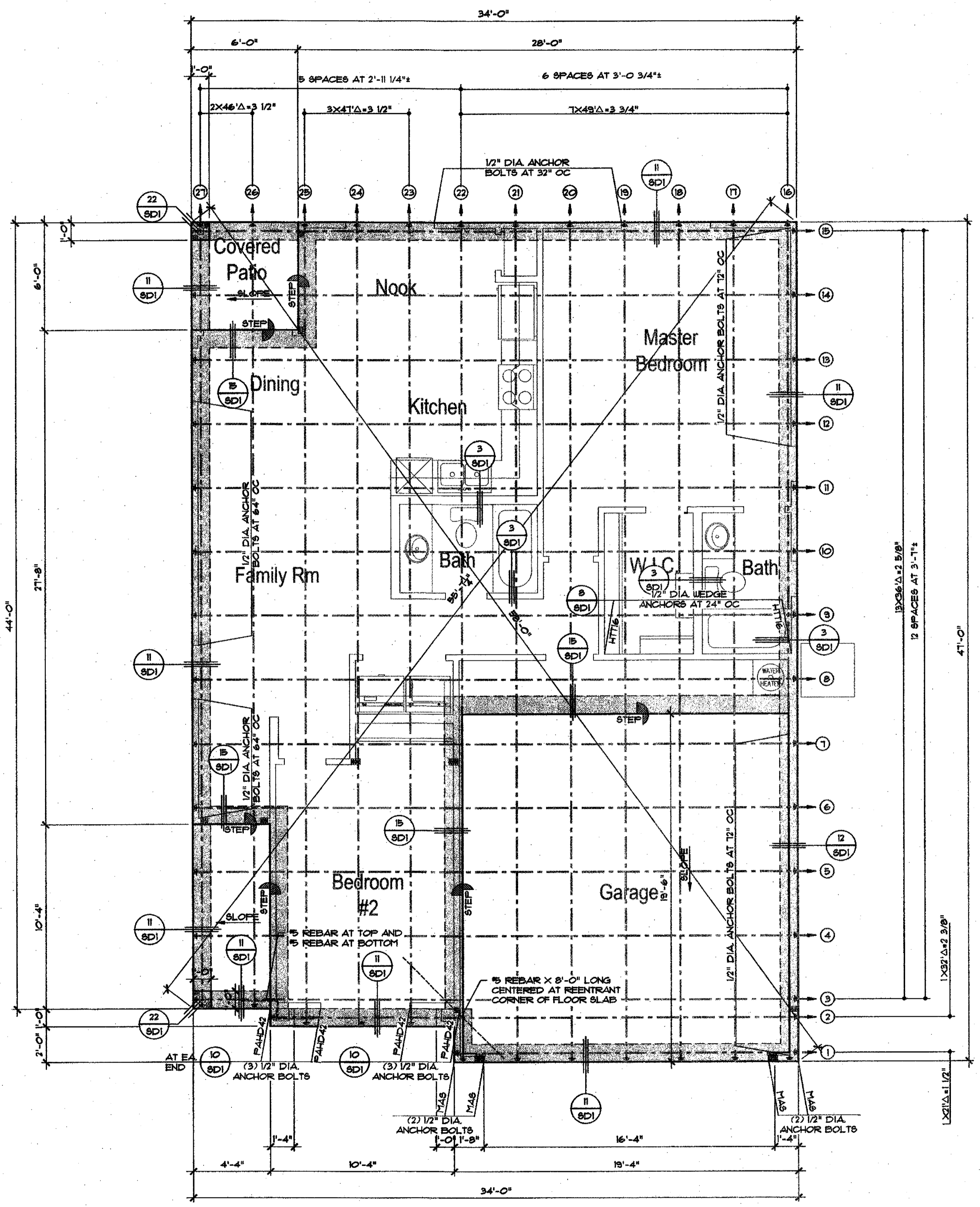

FOUNDATION PLAN A
ALL ELEVATIONS SIMILAR
REFER TO FOUNDATION PLAN 'A' FOR ALL INFORMATION NOT SHOWN. ONLY INFORMATION REVISED FROM FOUNDATION PLAN 'A' IS SHOWN FOR CLARITY.

REFER TO 50 SHEETS FOR ALL NOTES AND SPECIFICATIONS

PROJECT:
Broadway at San Marcos

OWNER/DEVELOPER:
Liberty Homes

ARCHITECT/DESIGNER:
MDW Designs

SHEET:
PLAN 1045

FOUNDATION PLAN

REFERENCE DATE: 03-29-07
ISSUED FOR:

CLIENT DELIVERY: 03-29-07

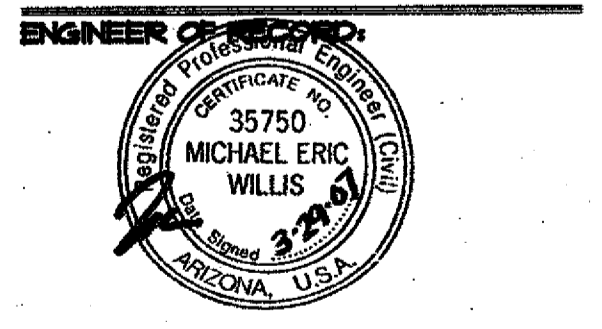

CONTACTS:
-For design questions regarding these plans and specifications contact the Project Manager:
Steve Danner
Telephone: (623) 869-0601 ext. 233
Facsimile: (623) 869-0603
Email: steved@borm.com
-For scheduling site observation and for field change contact the Construction Administrator:
Alicia Engel
Telephone: (623) 869-0601 ext. 232
Facsimile: (623) 869-0603
Email: aliaee@borm.com

FILE NO.: 12564
CAD NO.: 12564 1045 61-FND A
DRAWN BY: KER
ENGINEER: HI
SCALE: 1/4" = 1'-0"
SHT NO.: 511